

## Heavy Duty Thimbles

Stainless Steel T304 & T316

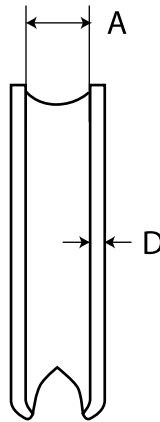
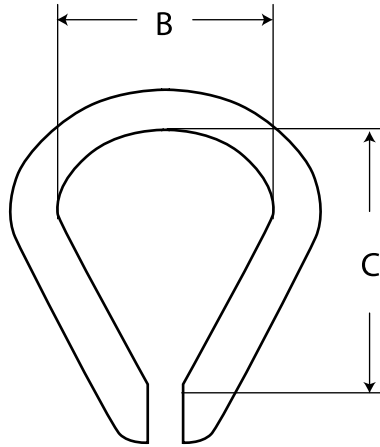

A	B	C	D	WT (lb)
3/16"	3/4"	1 - 3/8"	0.055	0.03
1/4"	7/8"	1 - 5/8"	0.68	0.07
5/16"	1 - 1/16"	1 - 7/8"	0.085	0.15
3/8"	1 - 1/18"	2 - 1/8"	0.12	0.24
1/2"	1 - 1/2"	2 - 3/4"	0.155	0.5
5/8"	1 - 3/4"	3 - 1/4"	0.18	0.72
3/4"	2"	3 - 3/4"	0.23	1.2
7/8"	2 - 1/4"	4 - 1/4"	0.24	1.46
1"	2 - 1/2"	4 - 1/2"	0.25	2.1